

FENCES

9-16-1 Fence Requirements: For the purpose of the Bartlett Building Code Ordinance, a fence shall be defined as an accessory structure which is a barrier and is used as a boundary, screen, separation, means of privacy, protection, or confinement, and is constructed of wood, plastic (PVC), metal, masonry, or other similar material. Fence permits are required for all new, enlarged, repaired, altered, and replaced fences.

- A. **Excess Fill:** Excess fill or soil from excavating fence must be removed from the property. If used, must accompany fill permit.

9-16-2 Height Limitations:

- A. **Residential:** No fence or wall may be erected, placed, or maintained on any zoned residential lot to a height exceeding six feet (6') above the ground level, except that no such fence or wall, which is located in a required front or corner side yard, shall exceed a height of three feet (3').

Where such lot line is adjacent to nonresidential-zoned property there shall be an eight foot (8') limit on the height of a fence or wall along such lot line.

- B. **Non-residential:** No fence or wall shall be erected, placed or maintained on any nonresidential-zoned property to a height exceeding eight feet (8').
- C. **Wire Fence:** The minimum gauge of wire for a wire mesh fence shall be not less than eleven (11) gauge, and the minimum size wire mesh shall be not less than two and one-quarter inches (2-1/4"). No chicken wire or barbwire fences shall be permitted on any residential lot.

9-16-3 Fence Location: No fence or other structure, nor any plant material, shall be so placed in the vision triangle as to obstruct the clear visibility of any intersection. The vision triangle, as defined in the Zoning Ordinance, is a triangular area determined by a diagonal line connecting two (2) points measured thirty-five feet (35') equidistant from the lot corner of the two (2) intersecting lot lines adjacent to the public rights-of-way.

Fences located in the interior side and rear yards shall have maximum height of six feet (6'). Fences located in the front yard shall have a maximum height of three feet (3'). A side yard adjacent to the public right-of-way shall be considered a corner side yard and shall be regulated as a front yard with a maximum fence height of three feet (3').

It shall be the homeowner's responsibility to make sure that any fence installed on his or her property is within his or her property line. No fence shall be installed directly on the property line. The bottom of a board fence shall be placed three inches (3") above grade (ground level) to assure that drainage swales will function properly. **If there is a better side to the fence, it is to be facing out.**

- A. Fence posts should be placed six inches (6") inside the owner's property on the side of the fence facing the owner's property. The depth of the fence posts should be one-third (1/3) of the height of the fence. **Exception:** In corners or supporting gates, the depth in this case shall be to frost. Fill should be base gravel with concrete fill six inches (6") below grade.
- B. Fences shall not be placed closer than eighteen inches (18") from telephone, ComEd, cable, gas, pedestals that would interfere with the maintenance for these utilities, if necessary. Fences shall not be placed on storm manholes, catch basins, or pipes. Exception: When an easily removable panel(s) is/are installed above catch basin or manhole.
- C. Homeowners are responsible for locating their sump pump line if buried in the backyard to avoid damaging it during construction. Swimming pool fences shall be regulated by the IBC[®] and the Bartlett Building Code.
- D. Swimming pool fences shall be regulated by the International Residential Code and the Bartlett Building Code.

Homeowners are responsible for locating their sump pump line if buried in the backyard.

Prior to digging, contact JULIE, the underground utility locating service at 1-800-892-0123.

BUILDING PERMIT REQUIRED

To apply for the building permit, the following items shall be submitted to the Building Department:

1. A completed permit application and a copy of the signed contract
2. Plat of survey showing the proposed location, type and height of the fence
3. The tax index number (PIN)

PERMIT FEE

The permit fee is based on the estimated cost of construction. Refer to BBC 9-3-5.

INSPECTIONS REQUIRED

Only a final inspection is required. The Building Inspector shall inspect all buildings and structures that are being erected, constructed, built, enlarged, repaired, altered, replaced, or moved. Inspections shall be requested in writing or by telephone to the Building Department at least twenty-four (24) hours in advance.

CONTRACTORS LICENSE REQUIRED

It shall be unlawful to engage in business in the Village of Bartlett as a building contractor without first having obtained a building contractor's license.

A homeowner is not required to be licensed as a subcontractor or general contractor to construct, demolish, rehabilitate, alter, or repair his or her own home. (This does not apply to new home construction permits.)

LICENSED CONTRACTOR

All names of licensed subcontractors and general contractors are on file in the Office of the Village Clerk and in the Building Department.

FENCE - GARAGE - SHED LOCATION

STREET

STREET

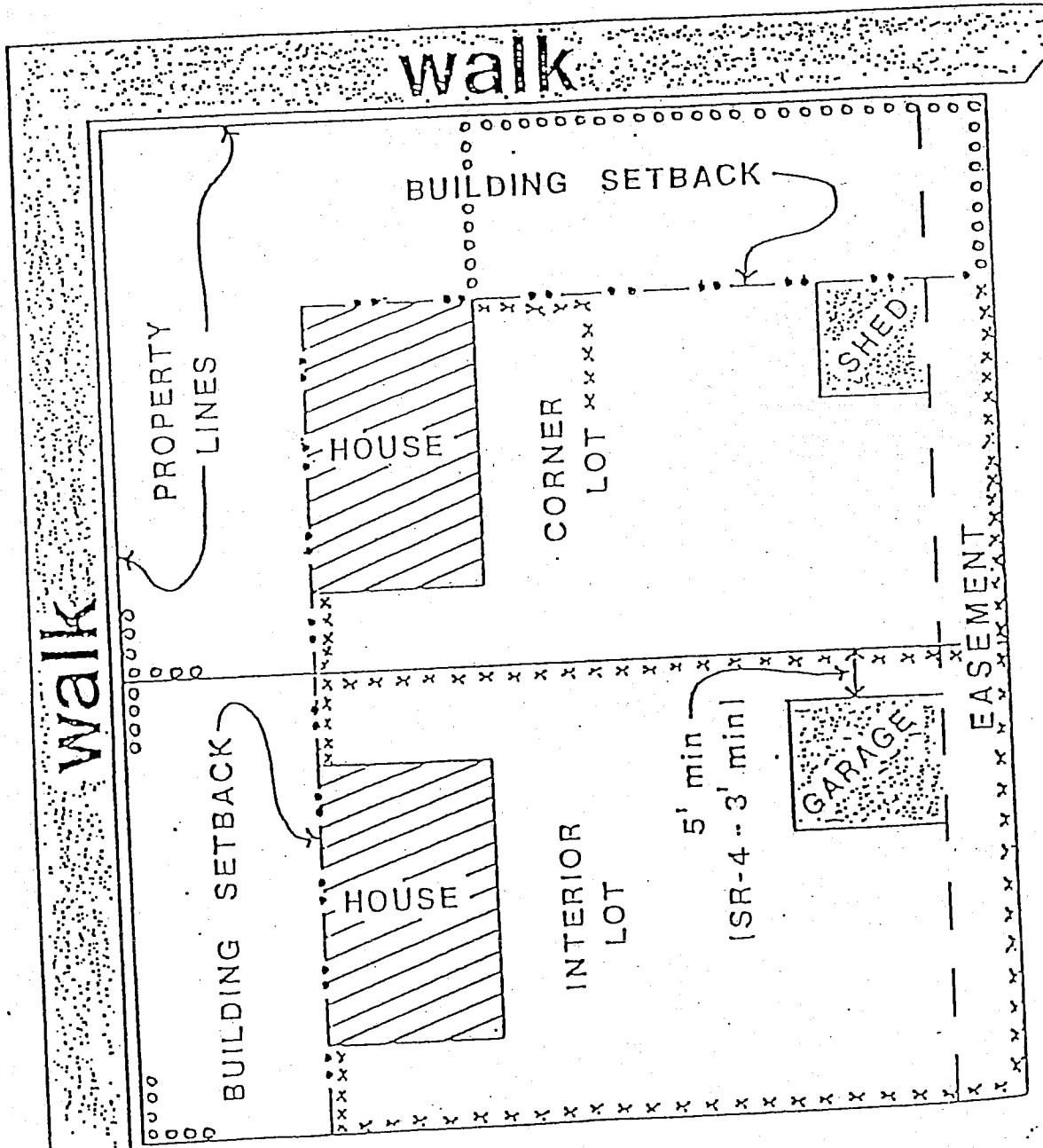

KEY:

- ooooo - 3' HIGH FENCE - MAX.
- xxxxx - 6' HIGH FENCE - MAX.